

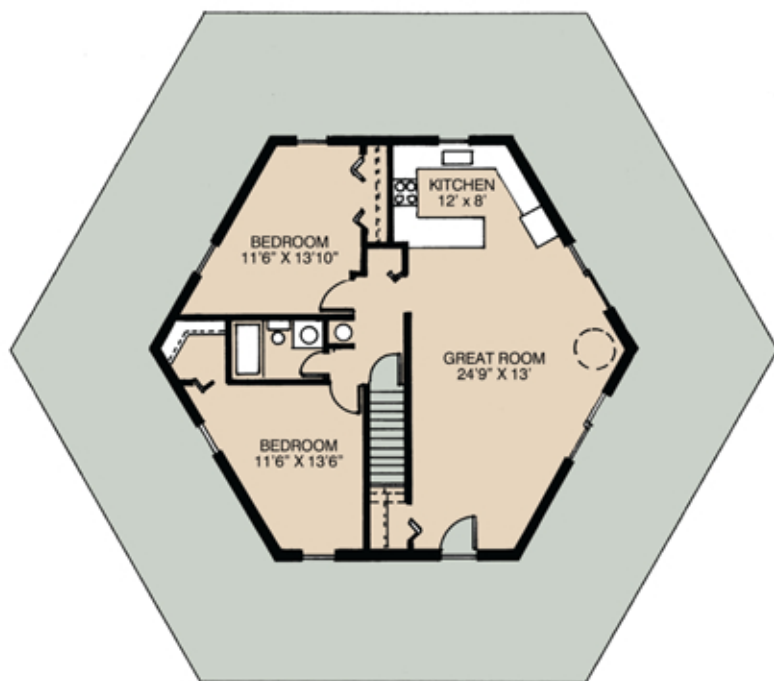

Our unique hexagonal designs entice the imagination with the 360° view. Large windows and sliding glass doors literally bring the outside in. Plan options range from 2 - 4 bedrooms. The Chesapeake features a higher roof pitch with a unique "look-out" from the turret, making it truly reminiscent of some lighthouses on the Chesapeake Bay.

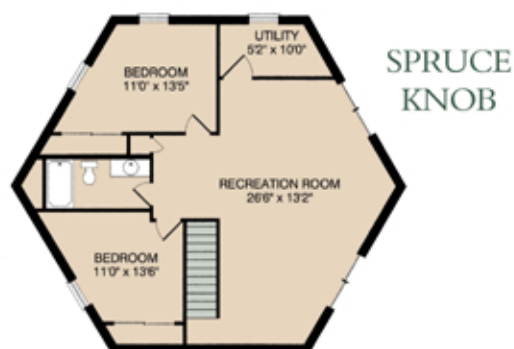

Main Floor Plan – CHEASAPEAKE



SPRUCE
KNOB

SPRUCE
KNOB
Optional
Basement



Spruce Knob: Overall Dimension: 34' x 40' / Living Area: 1,003 sq. ft. / Total with Finished Basement: 2,006 sq. ft.

Chesapeake: Overall Dimension: 41' x 48' / Living Area: 1,671 sq. ft. / Total with Finished Basement: 3,163 sq. ft.